

# Real HOMES

*More Space. More Light. More Wow!*

**AMAZING**  
**BEFORE  
+AFTERS**  
**54** PAGES OF  
INSPIRING  
MAKEOVERS

**SUMMER  
EDIT**

**GARDEN BENCHES**

**OUTDOOR RUGS**

**COLOURFUL  
PARASOLS**

## PROJECT CHECKLIST

Starting an extension?  
Read this first...

## ALFRESCO DINING

Everything you  
need for a stylish  
outdoor party

**GOING UP**  
IS YOUR LOFT  
PERFECT FOR  
CONVERSION?

## CREATE SPACE WITHOUT EXTENDING

Smart ideas to maximise  
the potential of your home

## EXPERT ANSWERS

What's the key to designing  
a successful room layout?

Can I repair skirting  
boards and coving?

How can I include a water  
feature in my garden?





#### SLEEK STYLE

Malmo high-level kitchen cabinets from the Burbidge Gloss White range are deeper than standard to increase storage without visual clutter. Three white pendant lights from Ikea, and stools from Scab Design complete the striking white kitchen. Ultra-durable treated matt oak flooring, from Natural Image, has been used throughout



BEFORE

#### STREAMLINED CHOICE

Right and below The dated downstairs (above) is now an airy kitchen/living space. Pristine white worktops and splashback in natural quartz from Silestone suit the look



AFTER

## *Real Homes* KITCHEN EXTENSION

# MODERN MINIMALISM

Siggi and Bruce Knepp used their architectural expertise to convert an ordinary house into a cutting-edge home





#### MINTY FRESH

**Above** The entire ground floor has been opened up to create a more contemporary layout. A one-off sample table by James Burleigh, with green formica top, is a striking centrepiece teamed with fibre-glass chairs found on Ebay. The eye-catching suspended light over the table is by Modiss

#### THE OWNERS

Architects Sigg and Bruce Knepp live here with their daughter, Else, nine, and golden cocker spaniel, Ariel

#### THE PROPERTY

A four-bedroom, neo-Georgian detached house in Tenterden, Kent

#### SIGGI AND BRUCE LOVE

Furniture store B&B Italia  
*Grand Designs*

Using green accents to link to the garden

#### Their room divider

Bartlett School of Architecture

#### Timeless quality pieces

The colour white

#### Simplicity and practicality

#### TOTAL PROJECT COST

£110,770

**SIGGI** and her husband Bruce were living in a loft-style apartment in Battersea with their daughter Else when they decided to make the move out of London. The Kent town of Tenterden was their location of choice thanks to its proximity to the capital – a must for Bruce's job. 'Originally we were going to buy my parents' house there, as they were planning to retire to Greece,' says Sigg. 'But converting their period property into a contemporary home was too big a job for us.'

The couple looked for their own property within walking distance of the town centre. When they first saw their current home, it had a dark, dated interior. 'The beauty of this property is that it's a relatively modern build to a good standard,' Sigg explains. 'I could see that opening up the downstairs and reconfiguring the original rooms would work, so I started drawing up plans as soon as we decided to buy.'

Sigg spent three months nailing down every detail to avoid unexpected costs. Even the lighting layouts were completed before the sale had gone through. 'Often people leave this for the builders and you can end up with switches in the way of shelving units,' Sigg says. 'These sorts of things can destroy a carefully thought-out design.'

Work on the house started in August 2010 but the family didn't move in straight away, choosing to stay with Sigg's parents nearby. The biggest part of the project was the kitchen extension, and Sigg had strong views on how ➤



the finished space should look. 'I like to keep things minimal and I'm a big fan of white,' she says. 'It was important for me to maintain a horizontal feel to the design of the kitchen to accentuate the width of the room.'

Extending to the side of the house and removing virtually all the internal walls downstairs created a large living space – perfect for the family's new kitchen. Siggie managed the whole project and was on site every day supervising the sub-contractors. 'My husband Bruce was busy setting up his own practice around then,' she says.

The initial project took eight months to complete, with the wraparound room divider between the kitchen and sitting room added three years after they moved in due to financial constraints. Siggie used the same high-gloss surface for the divider as for the kitchen units, continuing the clean, minimalistic feel of the space. A green-topped

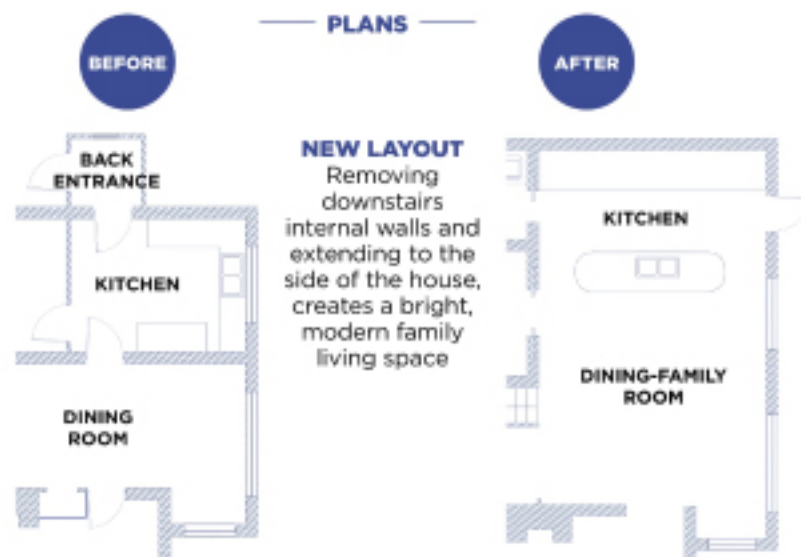





table and yellow chairs add a splash of colour. Siggie set up her own architect firm, Studio 9010, in 2011 and her house helps clients visualise how an outdated space can be transformed. 'I work from home so it's a great showcase,' she says. 'From outside it's an ordinary house, but it opens up into an unexpected contemporary living space.'

The family moved in just in time to celebrate Else's birthday with a party for 20 guests – as well as new puppy Arial. 'My daughter loves to sing and play the piano – the acoustics are brilliant,' Siggie says. 'It's a great space for us all to enjoy, and robust enough to deal with family life.' 🐾

#### DUAL PURPOSE

**Left** The room divider, with white units and doors from Burbidge, houses data and music systems plus a handy cloakroom. Tall radiator from Zehnder RZ Radiators. **Vases**, Muuto

#### FINISHED LOOK

**Below** The new kitchen has better access to the garden, and the sunny terrace is equipped with comfortable chairs and space to dine outside

#### COSTS & CONTACTS

Building works **£75,000**  
 Kitchen **£25,000**  
 Rooflights, windows & glazed doors **£3,500**  
 Oak flooring **£3,500**  
 Lighting & pendants **£2,770**  
 Decoration **£1,000**  
**TOTAL £110,770**

**Kitchen** Burbidge, 024 7667 1600, burbridge.co.uk  
**Building materials** Jewson, 02476 608235, jewson.co.uk  
**Worktop** Silestone, 01256 761229, silestone.co.uk

